

# Haier

## Smart Power Ducted Air Conditioning

Quiet and discreet whole-of-home heating and cooling.





## Our Brand

Empowering smarter, happier, and healthier living, Haier leads with smart technologies across a range of home appliances. Haier is the number one brand of connected air conditioner (including smart air conditioner) and the number one brand of healthy Self-Clean air conditioner in the world, measured in terms of retail sales volume in 2023.\*



### Award Winning

#1 SMART AIR  
CONDITIONING BRAND  
IN THE WORLD\*



### Global Scale

OPERATING IN  
160 COUNTRIES



### Innovation + Quality

10 R&D CENTRES  
GLOBALLY



### Service + Support

NATIONWIDE  
SUPPORT

### Heating and cooling expertise

As one of the world's largest heating and cooling brands, Haier, founded in China in 1984, offers a comprehensive range of industrial, commercial, and residential air conditioning and water heating products. These are trusted in homes and businesses across the globe.

In Australasia, Haier's strength is complemented by Fisher & Paykel, a trusted brand that is part of the Haier Group. Together, they leverage Haier's global reach and Fisher & Paykel's local service network to provide high-quality products and support to our customers in Australia and New Zealand.

### 5 year warranty

Enjoy peace of mind with a 5 year manufacturer's warranty on products with less than 25kW system cooling capacity.

Our goods come with guarantees that cannot be excluded under Australian Consumer Law. You are entitled to a replacement or refund for a major failure and compensation for any other reasonably foreseeable loss or damage. You are also entitled to have the goods repaired or replaced if the goods fail to be of acceptable quality and the failure does not amount to a major failure. Our Manufacturer's Warranty is in addition to any rights and remedies that you may have and is not intended to limit any rights you may have, under Australian Consumer Law or any other law in relation to our products.

\* Data source: Euromonitor International Ltd., measured in terms of retail sales volume in 2023, based on research completed by February 2024. Connected air conditioner is defined as air conditioners with connectivity capability to communicate with other appliances and/or other devices and/or consumers.



# Ducted Air Conditioning

Ducted air conditioning systems are the ideal option for comfortable heating and cooling without interrupting your interior, as the indoor units are hidden in the ceiling or under the floor.

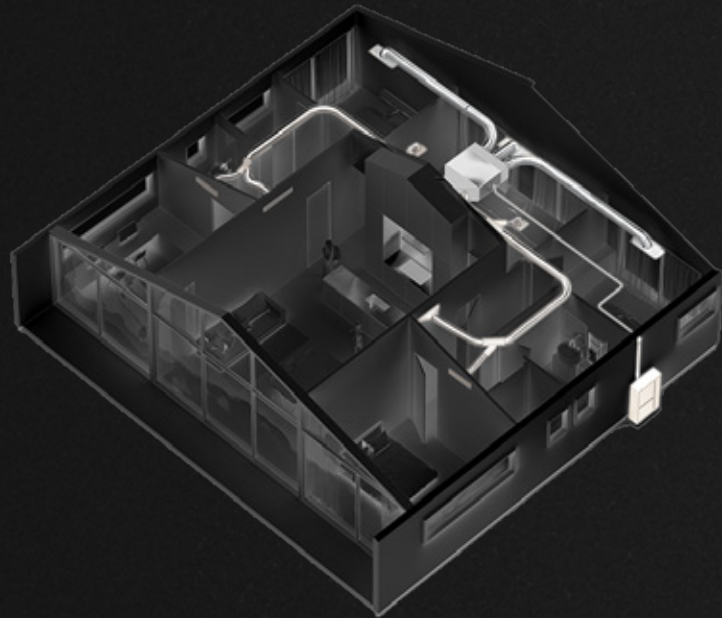

## Discreet appearance

Ducted air conditioning delivers discreet comfort. With no indoor units taking up floor or wall space, all you see of your heating and cooling system is the controller and unobtrusive grilles. One or more grilles where the system takes in the air to be conditioned (return air grille/s) and another where the system delivers the conditioned air to your room (supply air grilles).

## Whole of home conditioning

Ducted air conditioning is designed to condition your entire home, delivering a consistent and comfortable internal temperature, controlled by a single outdoor unit. By adding zoning to your system, you can turn on or off certain rooms or zones in your home to only heat or cool the areas you need to.

## Space saving

With one outdoor unit connected to heat or cool your entire home, you remove the need to install multiple outdoor units for each indoor unit, as you would need to for single split systems.

## Quiet

Ducted air conditioning systems are usually quieter inside than split systems as the indoor unit is concealed in your ceiling space, offering quiet operation.





# Haier Ducted Key Features

Haier’s Smart Power ducted air conditioning systems provide an effective whole-of-home heating and cooling solution suitable for homes and commercial spaces.

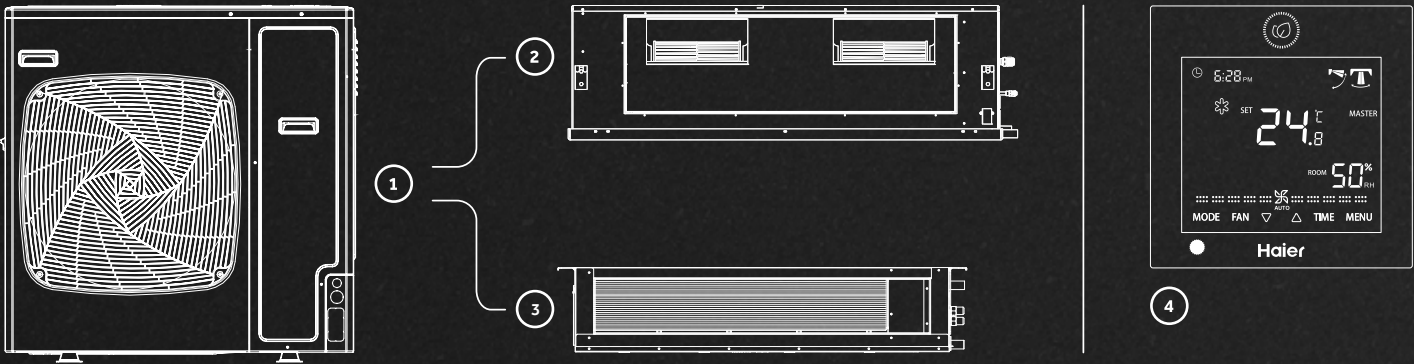

Haier’s ducted air conditioning range includes models to suit a range of building types, including compact units for situations where ceiling space is limited.

- ① **Smart Power outdoor unit**

Powerful capacity from 7kW to 28kW, the Smart Power outdoor unit is designed for quiet and energy efficient operation, due to the DC inverter, compared to other systems that do not have a DC inverter. Slim side discharge for all models.
- ② **High Static Ducted\***

Installed hidden in the ceiling cavity or under the floor for an uninterrupted interior, the high static ducted indoor unit delivers powerful heating and cooling to every room. Generally used in medium to large homes with a pitched roof.
- ③ **Low Profile Ducted\***

The low profile ducted indoor unit is designed for adaptable installation in tight spaces, such as between levels in multistorey buildings, for precise temperature control across multiple rooms. Generally used in small to medium homes, or when ceiling space is limited.
- ④ **A controller**

Either Haier or third party - that is used to control the whole air conditioning system.

## Whole of home conditioning

Create a consistent and comfortable temperature throughout your entire home with Haier’s ducted air conditioning. Rooms that are too hot or cold will be a thing of the past, as your entire home is conditioned for even and consistent comfort, including large open spaces. By dividing the home into zones, you have greater control and can turn the airflow off or on or change the temperature to individual zones.

## Zone control

Haier ducted air conditioners provide multiple options for zone control. Using the Haier zone controller, up to eight zones can be configured to suit your individual needs. Our systems are also compatible with most leading aftermarket zone control platforms. Please discuss your individual needs with your installer.

## Extensive range and operating temperatures

With capacities from 7kW to 28kW, we have a system that can heat/cool a variety of spaces, and delivers performance in most climates from -15°C to 46°C ambient air temperature.

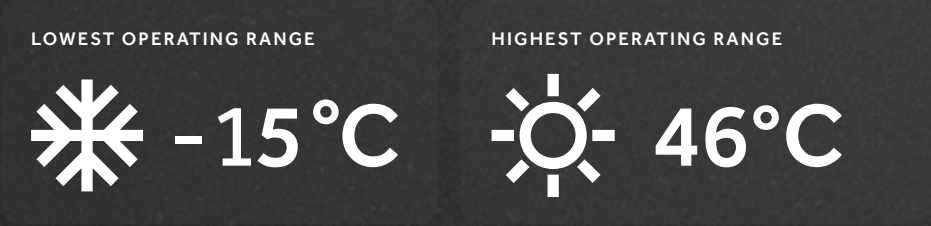

## Respect for the planet

R32 – the refrigerant used in your ducted system to transfer heat between the indoor and outdoor units – has a Global Warming Potential (GWP) of 675, 66% lower than alternative refrigerants like R410A (7-18kW systems only).

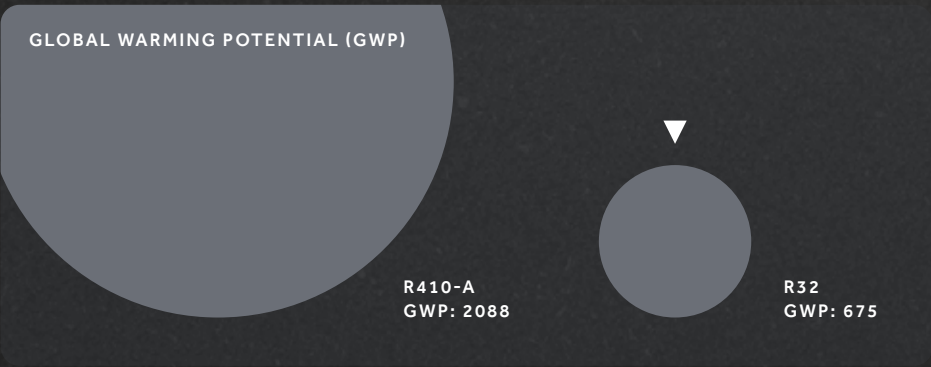

## Connected

The global No. 1 connected air conditioner brand\*, Haier makes life easier with convenient control of your Wi-Fi enabled appliances through the SmartHQ™ app. Wi-Fi can be added via an optional accessory.

\* Wi-Fi compatible with the addition of an optional accessory.

\* Data source: Euromonitor International Ltd., measured in terms of retail sales volume in 2023, based on research completed by February 2024. Connected air conditioner is defined as air conditioners with connectivity capability to communicate with other appliances and/or other devices and/or consumers.



Ducted air conditioning systems are the ideal option for comfortable heating and cooling without interrupting your interior, as the indoor units are hidden in the ceiling or under the floor.



Air control

A high performing ducted system needs to be able to get air to every corner of your home. Haier ducted systems feature DC fan motors that are quiet and efficient compared with AC fan motors. With 10 steps of static pressure adjustment, the system can be configured to ensure even the largest home systems are able to achieve effective cooling or heating performance.

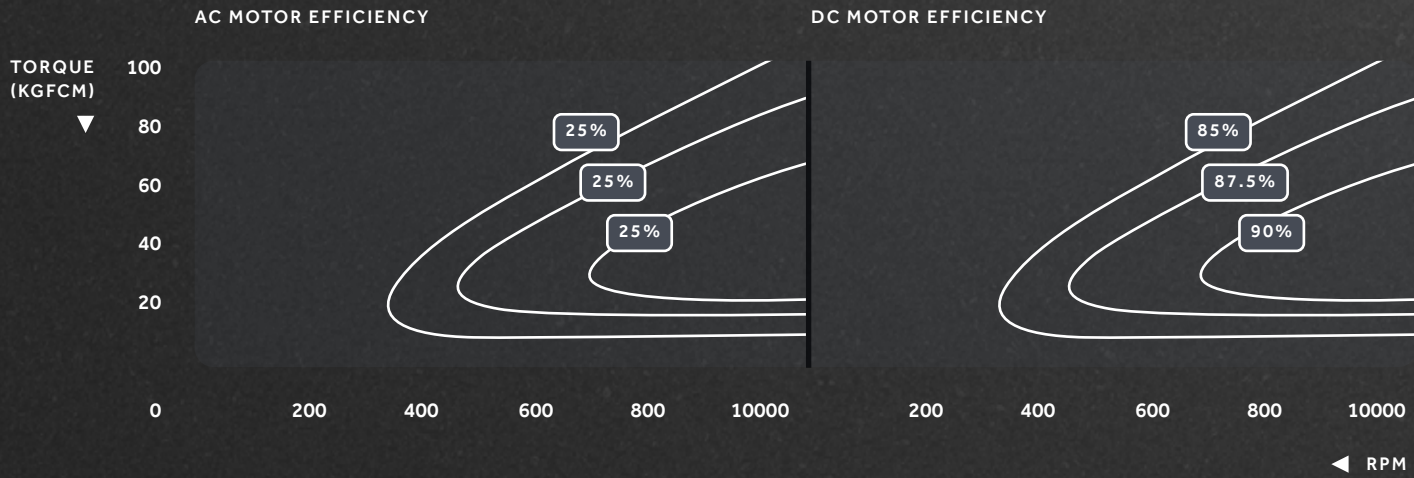

Quiet outdoor units

Quiet operation is achieved by our extra-large 550mm fan and a unique outlet grille that offers less resistance to airflow. Large fans have lower rotation speed leading to lower noise.

Ease of installation

With clever features designed to make access, handling and installation easier, these time-saving benefits should help your installer complete the install of your ducted air conditioner job more quickly. The 10-15.5kW ducted indoor unit fits easily between 600mm trusses for fast and simple installation. Also, some of the larger systems can be disassembled and reassembled inside the ceiling space when access is limited. A built-in condensate pump provides installation flexibility when a gravity draining solution isn't possible. (Low Profile Ducted models.)

Built for toughness and resilience

The outdoor unit coil features a Blue Fin coating that protects the unit, with strong corrosion resistance and super hydrophilic performance. High static indoor units have two built in drain trays for condensate removal (10-16kW), providing backup protection in case of an overflow due to blockage.



## Respect for the Planet

For the 7-18kW models, Low Global Warming Potential (GWP) refrigerants and technology to improve energy efficiency.



### Low GWP

R32 Refrigerant has a Global Warming Potential (GWP) of 675, 66% lower than alternative refrigerants like R410A.

### Zero Ozone Depletion Potential

Damage by chemical compounds of the ozone layer is measured by Ozone Depletion Potential (ODP). R32 has a ODP of 0, which means it does not harm the ozone layer.

### Inverter technology

An inverter compressor delivers the precise amount of heating or cooling capacity required, eliminating waste and minimising energy consumption.

## Connected

Haier's Smart Power ducted air conditioning systems are made Wi-Fi compatible with an additional accessory. In addition to the individual controllers, you can control your ducted system through the SmartHQ™ app on your phone if you have the Wi-Fi accessory.

### Control from anywhere

Arrive home to comfort by remotely controlling your air conditioner from anywhere.

### Connected home

With Haier and Fisher & Paykel appliances able to be connected to the SmartHQ™ app, you can check in and manage all your other connected appliances, as well as control your air conditioning.

### Intuitive hands-free control

With voice control through Google Home Assistant or Amazon Alexa you can control your air conditioner and ensure the perfect environment without getting off the couch. Try commands like 'Set the air conditioner to 20 degrees', or 'Turn off the air conditioner'.

### Control and monitor

Control temperature, operating mode and fan speed, all from your SmartHQ™ app. Check if you remembered to turn the air conditioner off, or set up a schedule to heat or cool your room to the perfect temperature.

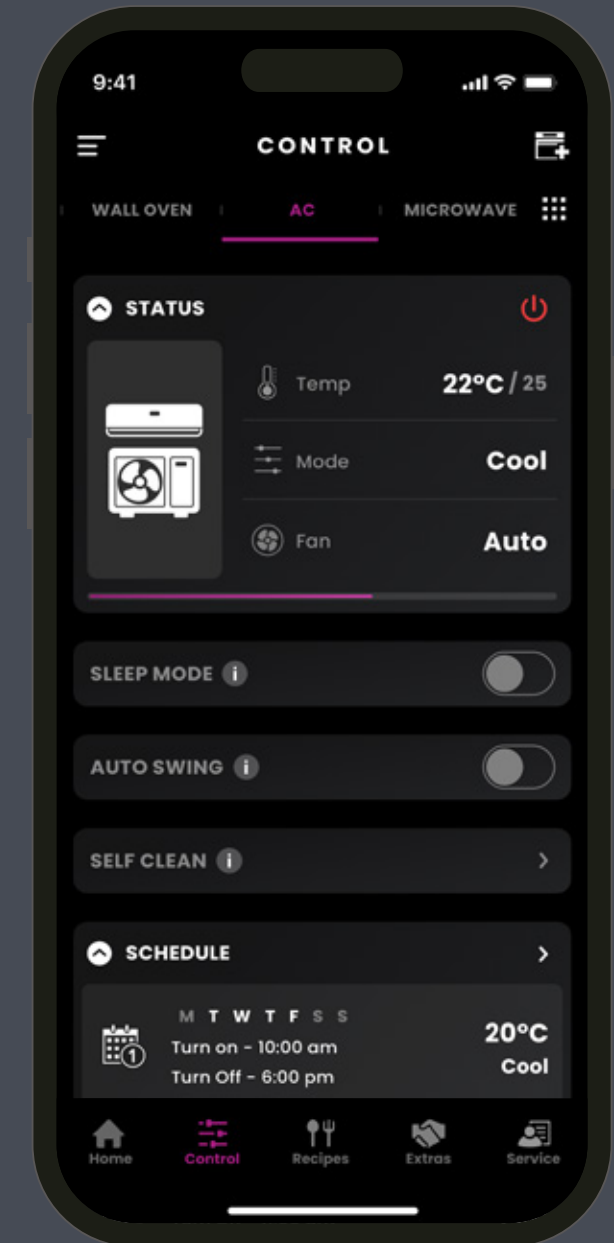



# High Static Ducted

The high static ducted indoor unit delivers powerful heating and cooling to every room, installed hidden in the ceiling cavity or under the floor for an uninterrupted interior.



## Compact

The high static indoor unit (10–15.5kW models) has a compact chassis, designed to fit in small ceiling spaces and between standard roof truss spacings of 600mm.

## Better airflow and efficiency

Powerful and consistent airflow to create a comfortable and consistent indoor environment. Using a DC fan motor, which are renowned for using less energy than a standard AC motor, this allows easy adjustment of the static pressure and airflow to tailor the conditioning of the space to your preferences.

## Faster installation

Considered features to make installation faster and more straightforward, mean less time until your space is conditioned for comfort. External Static Pressure (ESP) can be adjusted using the controllers, removing the need to open the electrical box and adjust by switch or plug. The 18 and 20kW indoor units can be separated into two manageable pieces, then reassembled in the ceiling. For 10–15.5kW units, top, bottom or side panels are removable for servicing and installation.

# Low Profile Ducted

The low profile ducted indoor unit is designed for adaptable installation in ceiling spaces where height is limited, such as between levels in multi-storey buildings, for precise temperature control across multiple rooms.

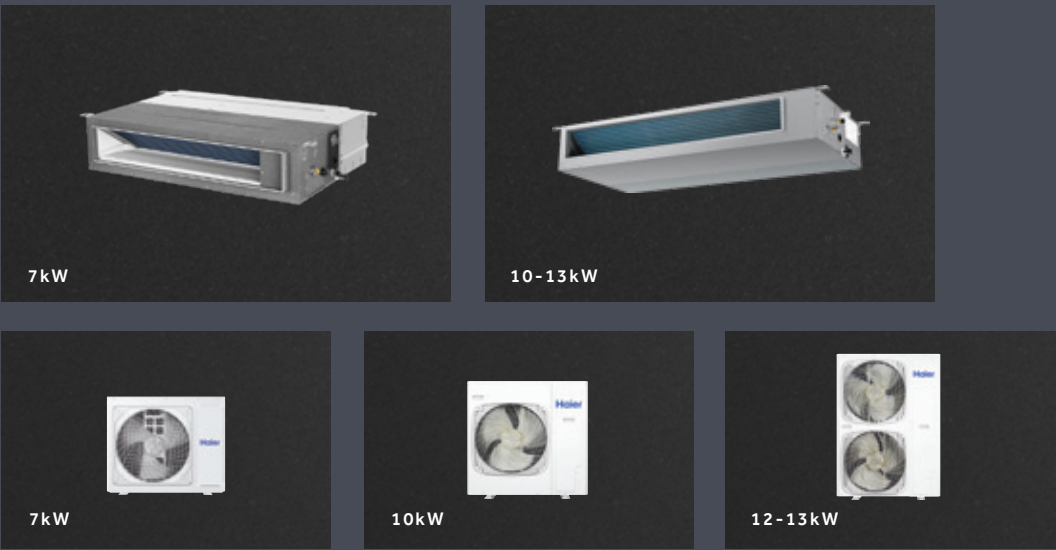

## Consistent airflow

Powerful and consistent airflow to create a comfortable and consistent indoor environment.

## Compact and slim

Designed with a super low height of 250mm to fit into tight spaces, this unit makes a ducted system possible where it would otherwise not be suitable.

## Flexible design

Your space should be designed around how you live, not the constraints of the ducting. That’s why pragmatic details like having three drain outlets – left and right, inbuilt condensate lift pump, the ability to convert the rear return air to bottom return air along with the supplied air filter, to suit your installation, and the super slim chassis, all combine for a flexible system that works with your home design.



## Ducted Control Solutions

Designed for easy readability to make operation quick and straightforward, the Haier controllers have large text and high contrast displays with simple-to-use buttons. From the standard touchscreen to an 8-zone controller, Haier wall controllers provide a straightforward interface to make comfort as easy as pushing a button.

Compatibility with some of the industry's most popular zone controllers including Polyaire AirTouch, Advantage Air 'MyAir' and Izone, make it easy to connect your Haier system into a third-party control system.

Standard touchscreen controller

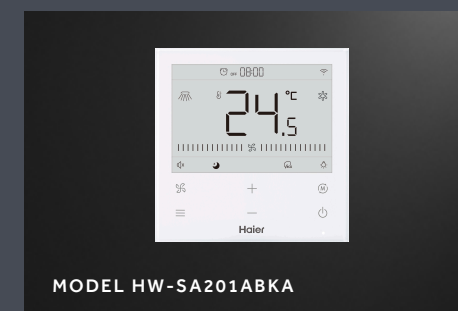

Full colour controller inc timer



8-zone controller



## Compatible third party zone controllers

Polyaire "AirTouch"



Advantage air "MyAir"



Izone

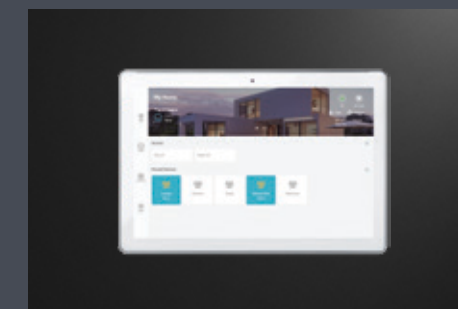



# Low Profile Ducted (R32) Specifications

	SET		AD71SMS5FA-SET	AD105MN5FA-SET	AD125MP5FA-SET	AD140MP5FA-SET	
Model	Indoor unit		AD71S2SM7FA	AD105S2SM7FA	AD125S2SM7FA	AD140S2SM7FA	
	Outdoor unit		1U71S2SS5FA	1U105SSN5FA	1U125S2SP5FA	1U140S2SP5FA	
Capacity	Cooling	kW nom	7.1	10.5	12.0	13.0	
		(min-max)	2.0-8.5	2.5-11.0	3.5-14.0	3.5-15.0	
	Heating	kW nom	7.8	12.0	14.0	15.0	
		(min-max)	2.0-9.5	2.5-12.0	4.0-16.0	4.0-18.0	
Power input	Cooling	kW nom	2.10	3.28	3.77	4.11	
		(min-max)	0.40-3.50	0.50-5.00	1.00-5.80	1.00-6.80	
	Heating	kW nom	2.20	3.43	4.01	4.29	
		(min-max)	0.40-3.50	0.50-5.00	1.00-5.80	1.00-6.50	
EER/COP		w/w	3.38/3.55	3.20/3.50	3.18/3.49	3.16/3.50	
AEER/ACOP		w/w	3.33/3.49	3.17/3.46	3.15/3.46	3.14/3.47	
TCSPF (Hot/Average/Cold climate)		Residential	3.964/3.609/3.631	4.124/3.82/3.918	3.947/3.678/3.760	4.134/3.858/3.977	
		Commercial	4.209/4.151/4.359	4.401/4.435/4.707	4.190/4.201/4.445	4.410/4.465/4.749	
HSPF (Hot/Average/Cold climate)		Residential	3.590/3.403/3.111	3.945/3.488/3.017	3.594/3.306/2.938	3.646/3.351/2.978	
		Commercial	3.576/3.453/3.216	3.94/3.672/3.176	3.581/3.407/3.018	3.634/3.455/3.060	
Model/Indoor unit			AD71S2SM7FA	AD100S2SM7FA	AD125S2SM7FA	AD140S2SM7FA	
Electrical parameters		Power input	Watt	200	200	375	375
Performance data	Air flow	l/s	402/333/263/194	555/483/383/355	625/544/466/416	694/600/494/416	
	ESP	Pa	25-150	25-150	25-150	25-150	
	Sound pressure level	dB(A)	42/38/35/32	44/40/37/34	45/42/37/34	46/43/38/35	
Installation	External dimensions		HxWxD mm	248x1100x700	248x1500x700	248x1500x700	248x1500x700
	Shipping dimensions		HxWxD mm	320x1290x840	330x1710x870	330x1710x870	330x1710x870
	Net/Shipping weight		kg	38/44	52/62	52/62	52/62
	Supply air connection		WxH mm	992x165	1392x165	1392x165	1392x165
	Return air connection		WxH mm	978x238	1378x238	1378x238	1378x238
	Drain		mm	Ø25 (OD)	Ø25 (OD)	Ø25 (OD)	Ø25 (OD)
	Water pump		mm	600	600	600	600
	Controller		Standard	/	/	/	/
		Optional	Touch	HW-SA201ABK	HW-SA201ABK	HW-SA201ABK	HW-SA201ABK
		Optional	Timeclock	HW-PA201ABK	HW-PA201ABK	HW-PA201ABK	HW-PA201ABK
			Wireless	RE-02 & YR-HQS01	RE-02 & YR-HQS01	RE-02 & YR-HQS01	RE-02 & YR-HQS01
			Wi-Fi	HI-WB101DEI	HI-WB101DEI	HI-WB101DEI	HI-WB101DEI
Model/Outdoor unit			1U71S2SS5FA	1U100S2SN5FA	1U125S2SP5FA	1U140S2SP5FA	
Electrical parameters	Power input	Ph/V/Hz	1/220-240/50	1/220-240/50	1/220-240/50	1/220-240/50	
	Rated current	Cooling	9	13.8	16.4	17.9	
		Heating	9.6	13.7	17.4	18.7	
	Max amps	Amps	16	23	26	30	
	Suggested breaker size	Amps	25	32	32	32	
Performance data	Air flow	m3/h	3200	4000	6500	7000	
	Sound Power	dB(A)	64	68	69	70	
	Sound pressure level	dB(A)	47	52	52	53	
Installation	External dimensions		HxWxD mm	760x920x372	950x370x965	350x950x370	350x950x370
	Shipping dimensions		HxWxD mm	820x1036x478	1050x450x1095	1500x1090x480	1500x1090x480
	Net/Shipping weight		kg	60/65	74/85	105/118	108/121
	Compressor type			Twin rotary	Twin rotary	Twin rotary	Twin rotary
	Refrigerant type			R32	R32	R32	R32
	Refrigerant liquid pipe		mm	9.52 (¾)	9.52 (¾)	9.52 (¾)	9.52 (¾)
	Refrigerant gas pipe		mm	15.88 (¾)	15.88 (¾)	15.88 (¾)	19.05 (¾)
	Max pipe length		m	50	50	75	75
	Max drop between I.U.&O.U		m	30	30	30	30
	Refrigerant qty		kg	1.7	2.3	2.9	2.9
	Pre-Charge line length		m	20	20	30	30
	Additional charge		g/m	45	45	45	45
	Working temp	Cooling (Min-Max)	°C	-15 to 50	-15 to 50	-15 to 50	-15 to 50
Heating (Min-Max)		°C	-20 to 24	-20 to 24	-20 to 24	-20 to 24	
DRED	Peak Smart (DRED) ready		Accessory HPRT-DRA001	YES	YES	YES	

# High Static Ducted (R32) Specifications

	SET		AD105HN5FA-SET	AD125HN5FA-SET	AD125HP5FA-SET	AD140HP5FA-SET	AD160HP5FA-SET	AD180HP5FA-SET	
Model	Indoor unit		AD105S2SH5FA	AD125S2SH5FA	AD125S2SH5FA	AD140S2SH5FA	AD160S2SH5FA	AD180S2SH5FA	
	Outdoor unit		1U105S5SN5FA	1U125S2SN5FA	1U125S2SP5FA	1U140S2SP5FA	1U160S2SP5FA	1U180S2SP5FA	
Capacity	Cooling	kW nom	10.3	12.5	12.5	14.0	15.5	18	
		(min-max)	2.5~12.0	4.0~14.0	3.5~14.5	3.5~15.0	3.5~17.5	5.3~18.5	
	Heating	kW nom	10.8	14.0	14.0	16.0	18.0	20.0	
		(min-max)	2.5~13.5	4.1~15.0	4.0~16.5	6.0~18.0	6.0~19.0	6.0~22.0	
Power input	Cooling	kW nom	3.05	3.89	3.68	4.43	4.83	5.63	
		(min-max)	0.50~5.30	0.50~5.30	1.00~5.80	2.00~6.80	2.00~7.00	2.0~7.0	
	Heating	kW nom	2.55	3.73	3.68	4.57	4.80	5.33	
		(min-max)	0.50~5.30	0.50~5.30	1.00~5.80	2.00~6.50	2.00~7.00	2.0~7.0	
AEER/ACOP		w/w	3.50/3.53	3.19/3.72	3.37/3.77	3.14/3.48	3.19/3.72	3.17/3.72	
TCSPF (Hot/Average/Cold climate)		Residential	4.502/4.115/4.225	4.254/3.960/4.088	4.003/3.731/3.788	4.404/4.110/4.285	4.236/3.974/4.108	4.173/3.9/4.022	
		Commercial	4.835/4.883/5.193	4.546/4.609/4.909	4.228/4.201/4.425	4.728/4.840/5.186	4.518/4.597/4.899	4.449/4.505/4.792	
HSPF (Hot/Average/Cold climate)		Residential	4.293/4.026/3.568	3.918/3.486/2.995	3.514/3.419/3.155	3.783/3.390/2.956	3.784/3.138/2.722	3.703/3.08/2.676	
		Commercial	4.279/4.105/3.738	3.906/3.525/3.158	3.491/3.417/3.210	3.775/3.427/3.089	3.768/3.416/2.921	3.686/3.165/2.868	
Model/Indoor unit			AD100S2SH5FA	AD125S2SH5FA	AD125S2SH5FA	AD140S2SH5FA	AD160S2SH5FA	AD180S2SH5FA	
Electrical parameters	Power input		Watt	540	550	550	600	600	
Performance data	Air flow		l/s	800/665/525/385	905/765/625/490	905/765/625/490	1000/865/725/585	1115/945/780/615	
	ESP		Pa	37~210	37~210	37~210	37~210	40~270	
	Sound pressure level		dB(A)	45/41/37/33	47/44/42/39	47/44/42/39	49/46/43/40	51/47/44/40	
Installation	External dimensions		HxWxD mm	425x1350x490	425x1350x490	425x1350x490	425x1350x490	500x1330x895	
	Shipping dimensions		HxWxD mm	510x1565x724	510x1565x724	510x1565x724	510x1565x724	568x1510x1037	
	Net/Shipping weight		kg	59/70	59/70	59/70	61/72	94/125	
	Supply air connection		WxH mm	1045x307	1045x307	1045x307	1045x307	958x377	
	Return air connection		WxH mm	1163x353	1163x353	1163x353	1163x353	1118x345	
	Drain		mm	Ø25 (OD)	Ø25 (OD)	Ø25 (OD)	Ø25 (OD)	Ø25 (OD)	
	Water pump		mm	/	/	/	/	/	
	Controller		Standard	/	/	/	/	/	/
		Optional	Touch	HW-SA201ABK	HW-SA201ABK	HW-SA201ABK	HW-SA201ABK	HW-SA201ABK	HW-SA201ABK
			Timeclock	HW-PA201ABK	HW-PA201ABK	HW-PA201ABK	HW-PA201ABK	HW-PA201ABK	HW-PA201ABK
			Wireless	RE02 & YR-HRS01	RE02 & YR-HRS01	RE02 & YR-HRS01	RE02 & YR-HRS01	RE02 & YR-HRS01	RE02 & YR-HRS01
			Wi-Fi	HI-WB101DEI	HI-WB101DEI	HI-WB101DEI	HI-WB101DEI	HI-WB101DEI	HI-WB101DEI
Model/Outdoor unit			1U100S2SN5FA	1U125S2SN5FA	1U125S2SP5FA	1U140S2SP5FA	1U160S2SP5FA	1U180S2SP5FA	
Electrical parameters	Power input	Ph/V/Hz	1/220-240/50	1/220-240/50	1/220-240/50	1/220-240/50	1/220-240/50	1/220-240/50	
	Rated current	Cooling	14.3	17.6	16	19.3	21	21	
		Heating	14.9	16.56	16	19.9	20.9	21.5	
	Max amps	Amps	24	23.2	26.0	30.0	31.0	31.0	
	Suggested breaker size	Amps	32	32	32	32	32	32	
Performance data	Air flow	m3/h	4000	4500	6500	7000	7500	7800	
	Sound Power	dB(A)	68	75	69	70	73	73/75	
	Sound pressure level	dB(A)	52	58	52	53	56	57/59	
Installation	External dimensions		HxWxD mm	965x950x370	965x950x370	1350x950x370	1350x950x370	1350x950x370	
	Shipping dimensions		HxWxD mm	1095x1050x450	1500x1090x480	1500x1090x480	1500x1090x480	1500x1090x480	
	Net/Shipping weight		kg	74/85	74/85	105/118	105/118	107/120	
	Compressor type			Twin rotary	Twin rotary	Twin rotary	Twin rotary	Twin rotary	
	Refrigerant type			R32	R32	R32	R32	R32	
	Refrigerant liquid pipe		mm	9.52 (¾)	9.52 (¾)	9.52 (¾)	9.52 (¾)	9.52(¾)	
	Refrigerant gas pipe		mm	15.88 (¾)	15.88 (¾)	15.88 (¾)	19.05 (¾)	19.05(¾)	
	Max pipe length		m	50	50	75	75	75	
	Max drop between I.U.&O.U		m	30	30	30	30	30	
	Refrigerant qty		kg	2.3	2.3	2.9	2.9	3.1	
	Pre-Charge line length		m	20	20	30	30	30	
	Additional charge		g/m	45	45	45	45	45	
	Working temp	Cooling (Min-Max)		°C	-15 to 50	-10 to 46	-15 to 50	-15 to 50	-15 to 50
Heating (Min-Max)		°C	-20 to 24	-15 to 24	-20 to 24	-20 to 24	-20 to 24		
DRED	Peak smart (DRED) ready			YES	YES	YES	YES	YES	







## Customer Care

Visit the website for more information

New Zealand: [haierhome.co.nz](http://haierhome.co.nz)

Customer support and service booking

New Zealand: [support.haier.co.nz/s/book-a-service](http://support.haier.co.nz/s/book-a-service)



LEARN MORE ABOUT  
OUR PRODUCT HERE

# Haier